

FOUNDATION LAYOUT

FOOTING SCHEDULE :-

FOOTING TYPE	FOOTING SIZE (A x B)	FOOTING THICKNESS (C)	REINFORCEMENT (BOTTOM) BOTHWAYS
F1	1800 x 1600	500	12@125c/c

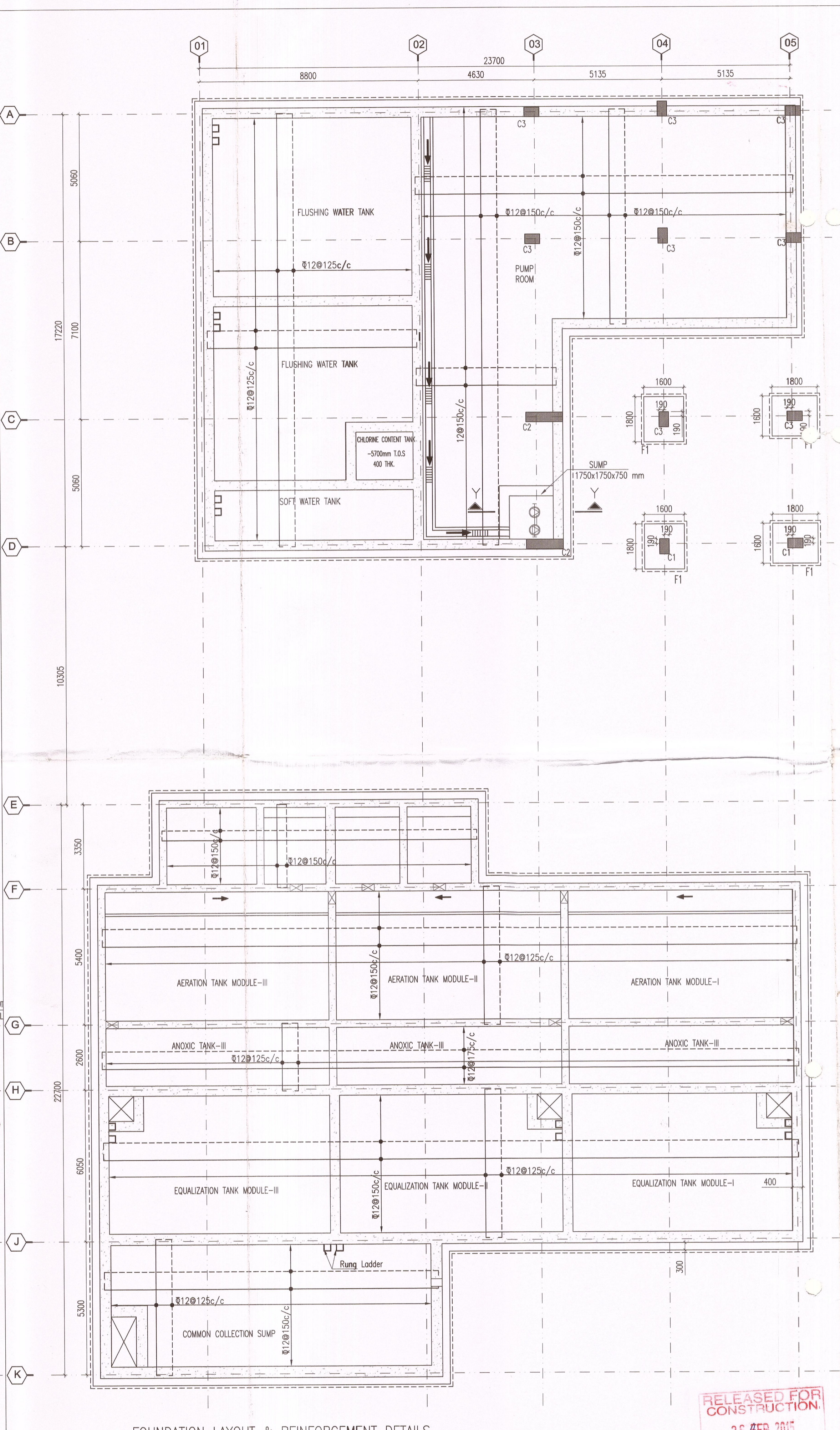

FOUNDATION LAYOUT & REINFORCEMENT DETAILS

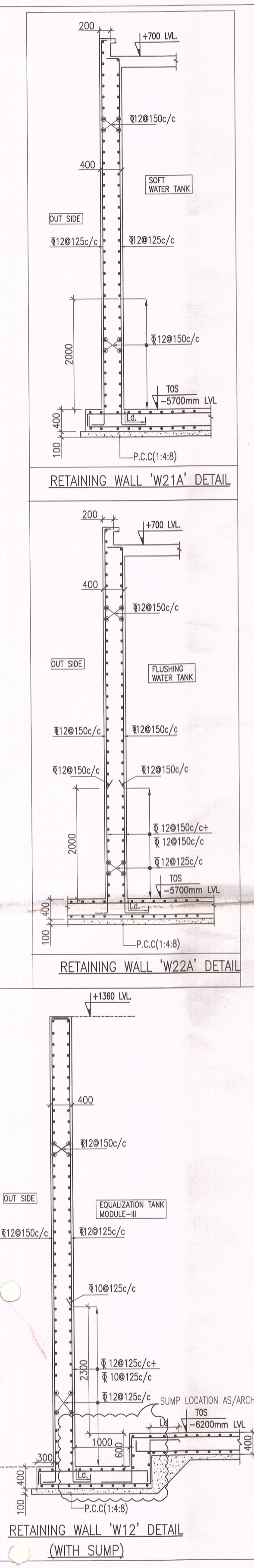

GOOD FOR CONSTRUCTION
26 Feb 2015
Arrop Associates Pvt. Ltd.
New Delhi, INDIA

RELEASED FOR CONSTRUCTION
26 FEB 2015
SIGNATURE OF TECHNICAL PROJECTS CONSULTANT'S PVT. LTD.

NOTES :- IF IN DOUBT ASK

- ALL DIMENSIONS ARE IN MM ONLY, UNLESS OTHERWISE SPECIFIED.
- DO NOT SCALE THE DRAWING FOLLOW FIGURED DIMENSIONS ONLY.
- PROVIDE A LAP LENGTH OF 40TIMES DIA OF SMALLER BARS WHEREVER LAPPING IS NEEDED .
- READ THIS DRG. ALONG WITH ARCHITECTURAL DRG. IN CASE OF ANY DISCREPANCY BEING NOTED IT SHALL BE IMMEDIATELY BROUGHT TO THE NOTICE OF THE CONSULTANT BEFORE COMMENCING THE WORK.
- THE CLEAR COVER SHOWN IN TABLE BELOW SHALL BE FROM THE OUTER FACE OF THE STRUCTURAL ELEMENT TO THE TIES FOR COLUMN AND TO THE MAIN REINFORCEMENT IN CASE OF FOOTINGS & RETAINING WALLS.

ITEM	GRADE OF CONCRETE	GRADE OF STEEL	CLEAR COVER
FOOTINGS	M45	Fe500	50 mm
RCC WALLS	M45	Fe500	40 mm

- LEGEND :-
- INDICATES BOTTOM REINFORCEMENT
 - INDICATES TOP REINFORCEMENT

NOTES :-
THIS DRAWING TO BE CO-ORDINATION WITH STP VENDOR SHOP DWG. BEFORE EXECUTION (FOR ANY SLEEVE/HANGER/HOOKS ETC LOCATION)

CLIENTS
Indian Institute of Technology(IIT) Hyderabad,
Ordnance Factory Estate,
Yeddumailaram-502205,
Andhra Pradesh, INDIA

ARCHITECTS & PLANNERS
ARCO ASSOCIATES PVT. LTD.
E-108, G.K. ENCLAVE PART 1
NEW DELHI 110048
PHONE : 011 - 26242050
FAX : 011 - 26242035

Structures TECHNICAL PROJECTS CONSULTANTS
DELHI OFFICE: HYDERABAD OFFICE:
E-2, CHURCH COMPLEX, SUKHDEV VIHAR, NEW DELHI-110025
FLAT NO 503, 5TH FLOOR, SRIVATSASA APARTMENTS, METHODIST COLONY, BEGUMPET, HYDERABAD-500016
TEL: 26823309, 26318650 TEL: (0091) 040-33574812
FAX: 011-26910652

Architect's Signature: _____
Client's Signature: _____
Executive Engineer (C), IITH.

Job Title: **26 FEB 2015**
IITH EXTERNAL SERVICES BUILDINGS

Drawing Title: **MBR BASED SEWER TREATMENT PLANT STP FOUNDATION LAYOUT**
Document Release Type: **GOOD FOR CONSTRUCTION**

Job No.	2012/09	N
Scale	1:100	
Date	01-12-2014	Drawing No.
Drawn by	MAHESWARI	ES-STP-01
Checked by	CHARY	Revision No.
AUTHORITY:		RO